

千斤頂

SCREW JACK

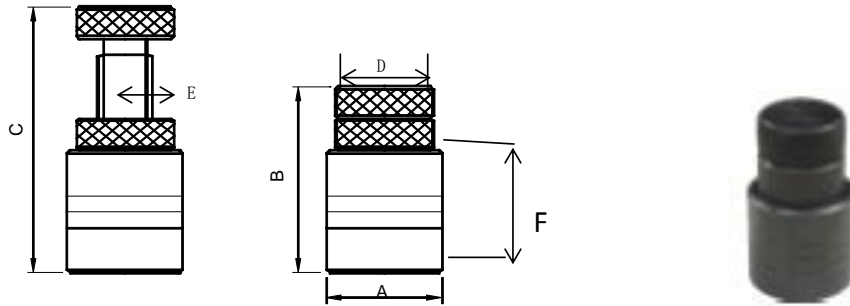

- ※ Material: S15C
- ※ Surface treatment: black oxide finished
- ※ Height is adjustable

Unit: mm

| Part no. | E | Applicable range (B-C) | A | D | F | Allowable loading (Tons) | weight (kg) |
|----------|------------------|------------------------|----|----|-----|--------------------------|-------------|
| S-70 | Tr14×3 | 56~75 | 32 | 25 | 30 | 4 | 0.26 |
| TS-100 | TW(19-6teeth/in) | 70-100 | 38 | 28 | 40 | 7 | 0.49 |
| TS-150 | TW(24-6teeth/in) | 95~150 | 50 | 38 | 70 | 10 | 1.2 |
| TS-250 | TW(30-6teeth/in) | 140~235 | 55 | 45 | 118 | 18 | 2.3 |
| TS-400 | TW(30-6teeth/in) | 230~425 | 55 | 45 | 200 | 18 | 3.8 |